



Northampton Facade

Facade Image for illustration purposes only. Please refer to working drawings.

LIMITED TIME ONLY

**Coloured
Concrete
Driveway Pack**

PLUS

**Timber
Flooring Pack**

PLUS

**Stone
Benchtops
Pack**

Jura16



Lot 337 Reflections Crescent LARA

Lot Size: 518m²

Northampton facade

Fixed Price Package Inclusions

- + 2440MM HIGH CEILINGS TO GROUND & FIRST FLOORS OF DOUBLE STOREY HOMES
- + TECHNIKA BELLISSIMO 600MM STAINLESS STEEL OVEN
- + TECHNIKA BELLISSIMO 600MM STAINLESS STEEL COOKTOP
- + TECHNIKA BELLISSIMO 900MM STAINLESS STEEL OVEN CANOPY
- + COLORBOND ROLLER DOOR
- + GAS DUCTED HEATING
- + POLISHED EDGE MIRRORS TO FULL WIDTH OF VANITY
- + FIXED PRICE SITE COSTS
- + 5 WEEKS TO CONTRACT
- + INTERIOR DESIGN INFLUENCED COLOUR SCHEMES

Contact: Alyshia Paraskevas 0429 623 237
porter-davis.com.au

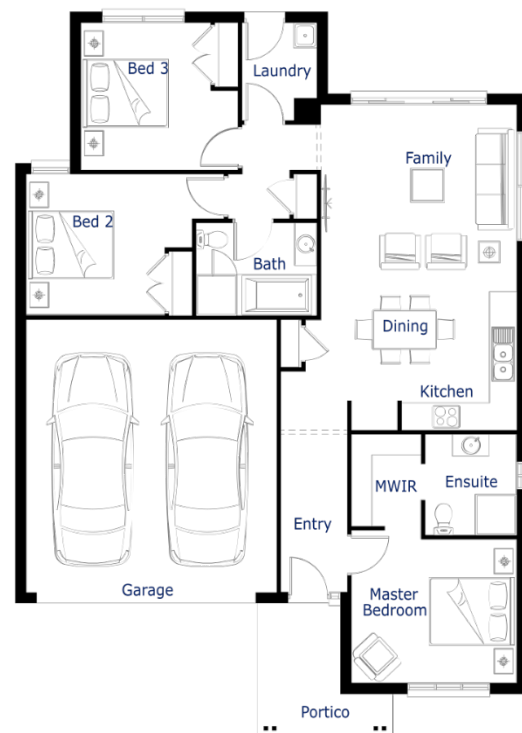

Lara Lakes

LARA

*Terms & Conditions: Package price is based on standard home, standard facade unless specified, builder's preferred siting and current promotion. Refer to sales consultant for actual working drawings for available facade options and inclusions. Pricing may vary due to actual land availability. Porter Davis reserves the right to change prices without notice. Fixed price packages are subject to developer's design review panel for final approval. \$2,000 non-refundable deposit only. First Home Buyer price less First Home Owner Grant subject to SRO eligibility criteria. If required via a town planning permit, client must provide landscaping and fencing etc at their own cost. Photos for illustration purposes only and include examples of upgrades not included in the package price. Refer to working drawings. Guaranteed site start subject to land title and finance availability. Geographic build zones apply. BAL rating up to 12.5 included, based on the standard home and specification. Should client variations after the requirements to achieve compliance, Porter Davis will debit or credit the client via a post contract variation. Package price correct at 22-06-2022.